

Welcome

Mines Douai

2013



*Welcome to Mines Douai.
Please find here all the information you need
to feel at home.
We hope you will enjoy your stay both
academically and culturally.*

*BDE (Bureau des Eleves) 2013-2014
Student Union 2013-2014*



The city of Douai

Medium-sized city, Douai is located in the region Nord-Pas-de-Calais region (France). Its citizens are called the « douaisiens »



A historical and cultural heritage

Come and discover the belfry and his peel of bells, the chartreuse museum, the churches and the collegiate church Saint Pierre.

Many facilities

The town is equipped with various facilities: stadium, swimming pool, Stake Park and many others are waiting for you.



To know what the city offers, simply ask the tourist information centre.

70 Place d'Armes
03 27 88 26 79



The city of Douai

In the centre of Europe

Douai is surrounded by many European towns. During your stay, do not hesitate visiting Paris, London, Brussels (capital of Belgium), Amsterdam (capital Holland) and Berlin (capital of Germany).



Lille

30 minutes away from Douai, Lille is one of the largest cities in all of France. There, you will find department stores, bars, nightclubs and other attractions.

Go to Lille by train:
Time taken: 25 min
Cost: 6 €60 one-way ticket
Finish: centre of the city.



Benefit from discounts on your fares: buy a ticket called « **carte 12-25** » at the railway station (the company you'll have to deal with is the **SNCF**)!

Cost: 50€
Validity: 1 year
The single fare for Lille will only cost 5€ maximum.
Paris will cost you 22€ instead of 48€ (one-way ticket).

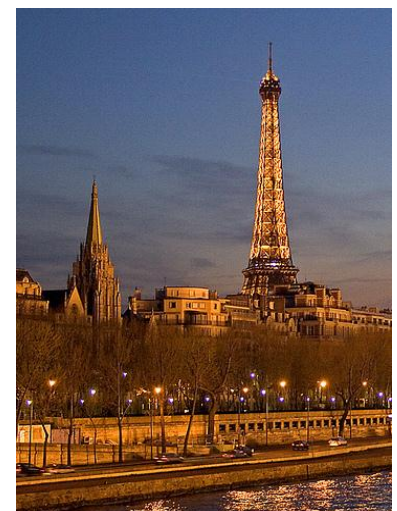

The MDE

La Maison Des Elèves (the students' house)

Called the « Meud » by students, the MDE represents a group of Mines Douai's student residences:

- Lavoisier
- Descartes
- Condorcet.

Each one has a parking lot for cars and bicycles and a certain number of bedrooms.

The rent for a bedroom is 320.47€ per month for the year 2012/2013.

Important: to access each residence you have to use your student card. Pass it on cases next to doors.

Car owner? You can ask to rent a parking space.

Bicycle owner? You can park your bike for free in a bike shed. (Don't forget to inform the administration).



Lavoisier Residence

It is the largest residence. Most activities take place there (parties, screening, fitness room...)

Resident officer:

Arnaud CARION – 06 60 45 46 57

Surface : **10,50 m²**.



Toilets are shared. There are located in your corridor.



You share a shower with your neighbour. We call this person « co-douche ».

Address

Résidence Lavoisier
263, rue du Grand Bail
59500 Douai
France

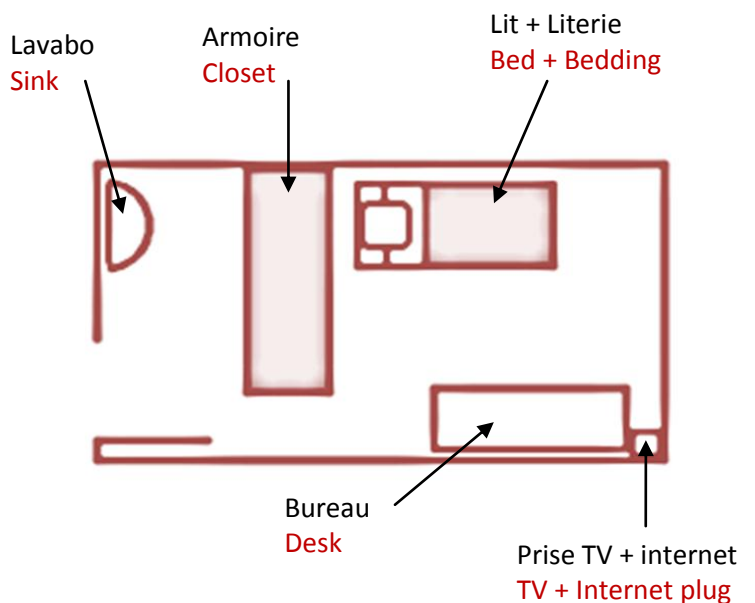

At the residence Lavoisier you can find:

RDC At the Ground-floor

The Games

Ping pong tables
Snooker tables
A table football

→ You can play every day from
7 a.m. to 10 p.m.

The Bar

→ Opens every night from
9p.m to midnight (except
Fridays and Saturdays).

One Tuesday per month, the bar
turns into a nightclub thanks to the
sono club.

These parties are called « Zinzin ».

1 1st floor

The fitness room

→ Opens every day from 7
a.m to 10 p.m.

2 2nd floor

The screening

→ Some nights, movies
are screened.
You are informed by
mail.



Descartes residence

Because certain bedrooms are rented by
external people, usually, there are no activities
in this place.

Resident officer:

Daniel SZYMKOWIAK - 03 27 71 49 03

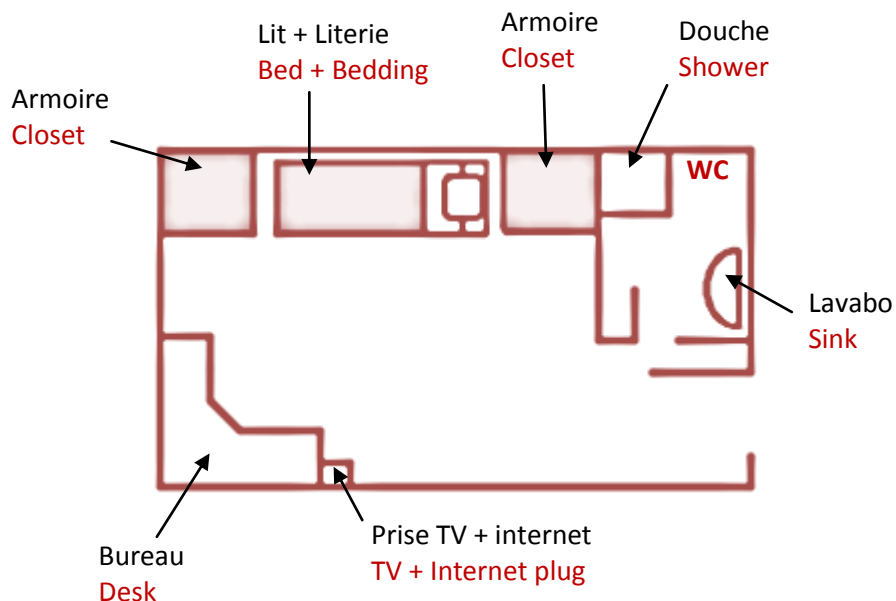

Meud's important places

The launderette

Each residence has a launderette in the basement (in the garage).

Costs:

- 2€ for the washing machine
- 1€ for the tumble dryer (or 1€50 if you want to use it longer).



The « Kitchens »

In almost each floor are kitchens called «kitchens». You can find a microwave, electric hotplates and a refrigerator in each one. They are available the weekend. Therefore, ask the key in advance to M. Rusek (his office is behind the snooker table).

Don't forget to return the key quickly after having cleaned the place.

The Canteen

It is located at Lavoisier.

At your arrival, you will have few days to choose how many meals per week you would like to eat there.

2012/2013 costs are given below:

- 7days/week (breakfast + lunch + diner):
320.47€/month
- 7 days/week (lunch OR diner): **131.97€/month**
- 5 days /week, it means without the weekend: (breakfast + lunch + diner): **149.69€/month**
- 5 days/week (lunch OR diner): **104.88€/month**

Opening times:

- In the morning: 7 a.m. -> 8h15 a.m.
- Lunch time 11h45 a.m. -> 1h30 p.m.
- Diner time 6h30 p.m. -> 8h p.m. (sometimes 8h30)



Pass your student card in front of the machine upstairs and take your tray.

You are allowed to take a first course (buffet), a course, a yoghurt or a dessert and some bread.

Sport

You can choose among these disciplines:

- Self defence
- Aqua gym
- Athletics (+ cross)
- Rowing
- Badminton
- Basket-ball
- Gymnastics
- Hand-ball
- Wrestling
- Body-building
- Football
- Golf
- Archery
- Orienteering
- Modern dance
- Equitation
- Climbing
- Fencing
- Fitness
- Swimming
- Scuba diving
- Rugby
- Stretching
- Tennis
- Table tennis
- Ultimate



Methods

Thursday afternoons are dedicated to sport.

At the beginning of your academic year you will have to choose your **sport n°1**. Your presence in that sport is **compulsory**.

In addition you can choose another discipline as **sport n°2**. There is no assessment in your 2nd sport.

To practise all sports, a **medical certificate** is to deliver to M. Maxime Hardouin. (His office is in Bourseul).





Don't hesitate to ask for more information on these sports and to try them.

Associations and clubs

During your stay, you will never be bored. Indeed, many associations, committees and clubs organize events every week at the Meud.

Representatives of each association are regularly on duty on lunchtime: don't hesitate questioning them so you could go to some events!

Among the associations there are:

Elected by students	The BDE (Bureau Des Elèves) ~ Equivalent to the Student Union	He lives up the community service. He also represents students to the administration.	
	The BDA (Bureau Des Arts) ~Arts Bureau	Organises trips in Europe and other cultural outings.	
	Le BDS (Bureau Des Sports) ~Sport Association	Organises sports outing.	
	Le BDH (Bureau Des Humanités)	It's the school's humanitarian association.	

- **The AIR:** computer science association. They can help you with your computer problems.
- **Artémis:** similar to a Junior Enterprise.
- **The Caméléon:** releases one newspaper per month
- **The Cartel des Mines:** annual tournament between European School of Mines.
- **The CCE:** go yatching for the "course-croisière EDHEC" or for the Colas Trophee.
- **The Envolée Nordique:** allows you to practice cross-country skiing for 2 days.
- **RKGE:** Rassemblement kayakiste des Grandes Ecoles. (*Grandes Ecoles Kayaker meeting*)
- **The Eurotandem:** 4000 km in tandem bicycle in favour of blood donation!
- **Danse committee:** learn how to dance salsa, rock, hip hop...
- **Oenology club:** taste different sorts of wine and cheese.
- **Au Fil Du Jeu:** organises board games' sessions.
- **The sono club :** is in charge of the music during parties.
- **The massage club**
- **The pom-pom girls**
- **The music club**
- **Club vidéo**
- ...

The administration

At Meud:

M. Rusek : Meud's headmaster

If you have important questions regarding the Meud, his office is just behind the snooker table.

Example: To put up a friend in your room for a maximum of 2 nights, you have to tell him one week in advance.

You can also contact him by mail: jean-pierre.rusek@mines-douai.fr

Mylène: secretary

She can also answer your questions. Her office is next M. Rusek's.

You have to see her or to inform her by mail if you want to reserve a kitch.

mylene.haire@mines-douai.fr



Both are ready to help you. However, ask your mentor or your colleagues: we may have your solution!

The accountant: he is in charge of your payments.

His office is located in Lahure. Checks are made out to the "agent comptable des Mines Douai".

Daniel SZYMKOWIAK /Arnaud CARION: Resident officers Descartes/ Lavoisier.

According to the residence you live in, if you have a problem in your bedroom, they are here to help. Their offices are situated in each hall.

Availability: 9 a.m. → 1 p.m. and 3p.m. → 7 p.m.

Don't hesitate do ring the doorbell (one time only).

Mrs Leonardis: She is in charge of all canteen stuffs.

She is on duty on Mondays and Thursdays noon down the canteen's stairs.

The rest of the time, her office is in Lahure.

At school:

Karine Kominiaz:

Go to see her if you have an administrative issue during your stay. You already know her: She greeted you at your arrival. Her office is in Bourseul, at the end of the ground floor opposite the auditorium 401.

Around the Meud

Want to shop? (Food, hygiene...)?

- **2 min from the Meud :**
Supermarket Match.
Rue du Kiosque
- **15 min from the MEUD :** (some items are cheaper)
Carrefour market
Place d'Armes

Want to have fun?

- **Cinema:** The Majestic, 20 min walk.
Price for one ticket: 4€70.
- **Bowling and Laser Game:** they are located nearby the cinema.
Prices: around 3 to 4€ for the bowling and 6 to 8€ for the laser game.

Show your student card to enjoy discounts!

Hungry?

- **Le TopKapi:** 10 min walk is a shish kebab stand: rue de la Mairie.
What is it? It's sandwich filled with mouton, served with French fries.
5€ for a kebab and a drink.
 - **The Pasta Bar:** 118 Rue de la Mairie
You can benefit 20 % discount on all menus.
Opening times: only for lunchtime.
Possibility to book a table on Sunday nights if you're at least 20.

Need a restaurant?

- **The Taormina,** 12 min walk.
You can enjoy a good meal for less than 15€.
- **The pataterie** where you can enjoy potatoes and cheese.
You can eat there for less than 10€.



If you're sick, you can buy drugs to the drugstore.



Want a show?

Douai's theatre and racecourse are here for you.

Find more information on:

www.hippodromedouai.com

<http://www.ville-douai.fr/douai.asp?idpage=14004>

Dear new students,
We hope this brochure will help you to adjust your new life in Douai.
If you have any questions or issues, we'll be glad to help you.

Foreign department, in charge of welcoming foreign students:

Head of the foreign department
Ms Hanaë SAID
hanae.said.ahmed@minesdedouai.fr
06 61 54 47 08
Room 4036 (Lavoisier).

M. Ya GROSSI ANDRADE
ya.grossi.andrade@minesdedouai.fr
07 78 68 73 63
Room 1046 (Lavoisier)

Others

Head of the BDE (Bureau Des Elèves)
Ms Fleur RAZAKARIVONY
fleur.razakarivony@minesdedouai.fr
06 70 73 26 81
Room 4032 (Lavoisier)

CAPA (Comité d'accueil pour les Premiers Arrivants), *in charge of welcoming new students in September.*
Ms Julie PLIEZ
julie.pliez@minesdedouai.fr

06 68 8

Prices indicated in this booklet vary according to academic years.